

Checking the Futura Wi-Fi Hotspot and signal strength

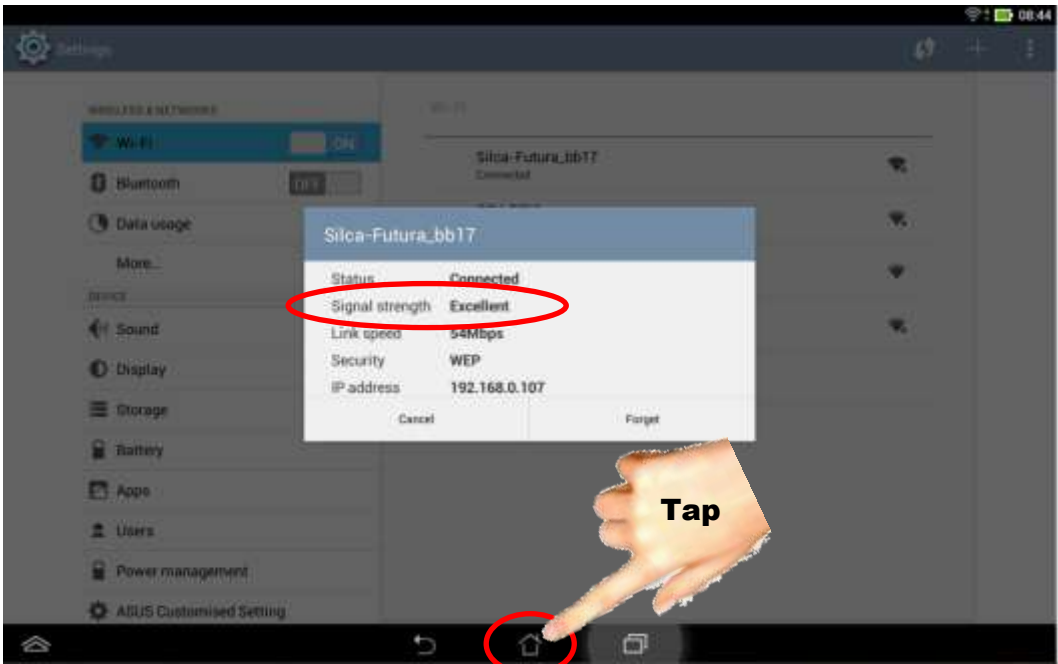

Tap to return to home page

Apps to clear Cache

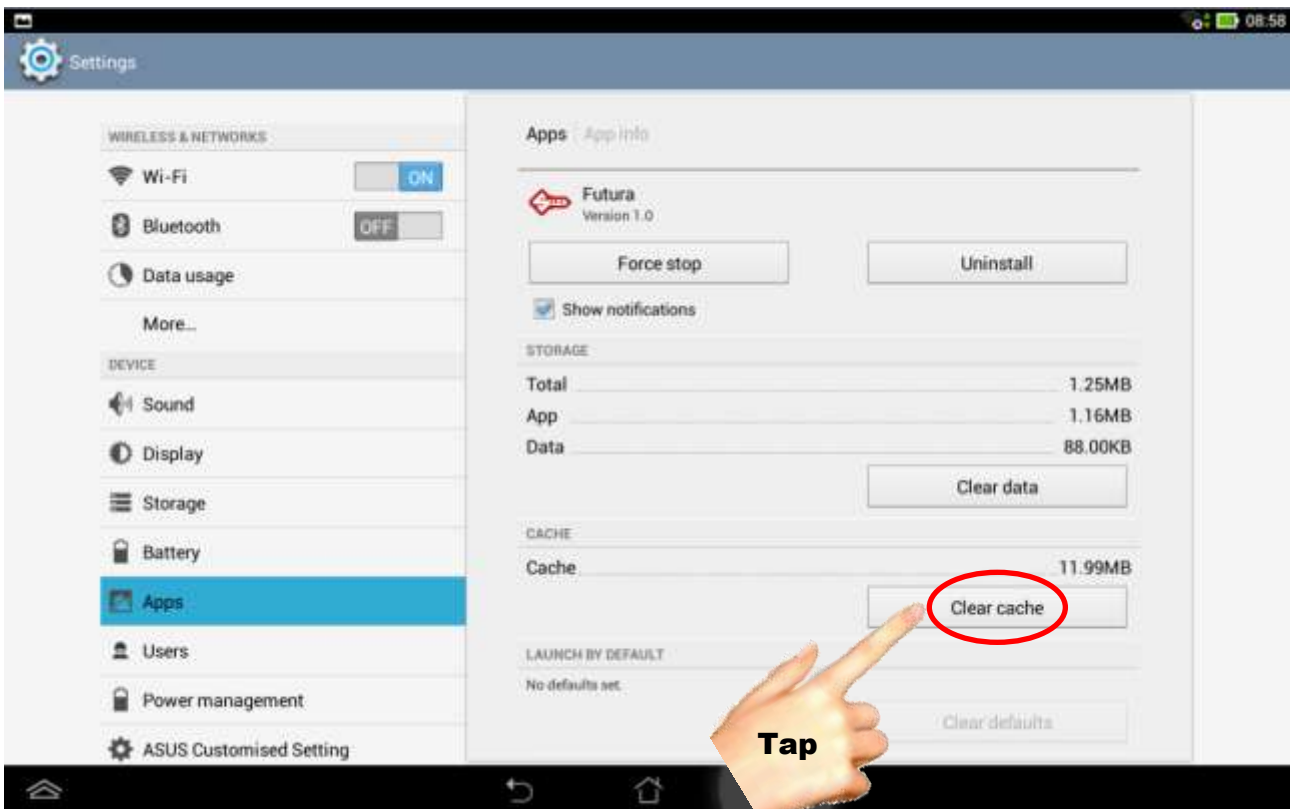
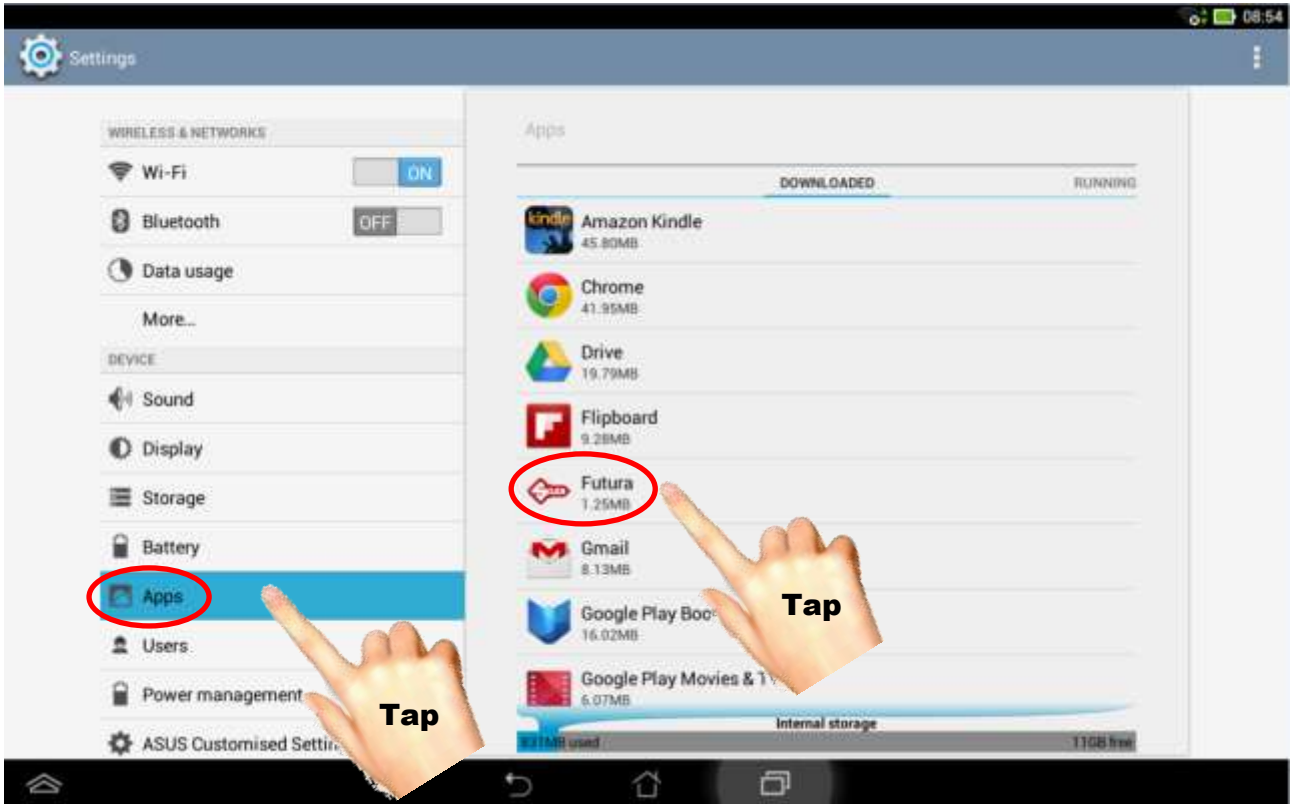

Tap to clear cache

Inserting the password (which should be the Futura machines serial number) to be able to connect to the (Wi-Fi) Futura machine.

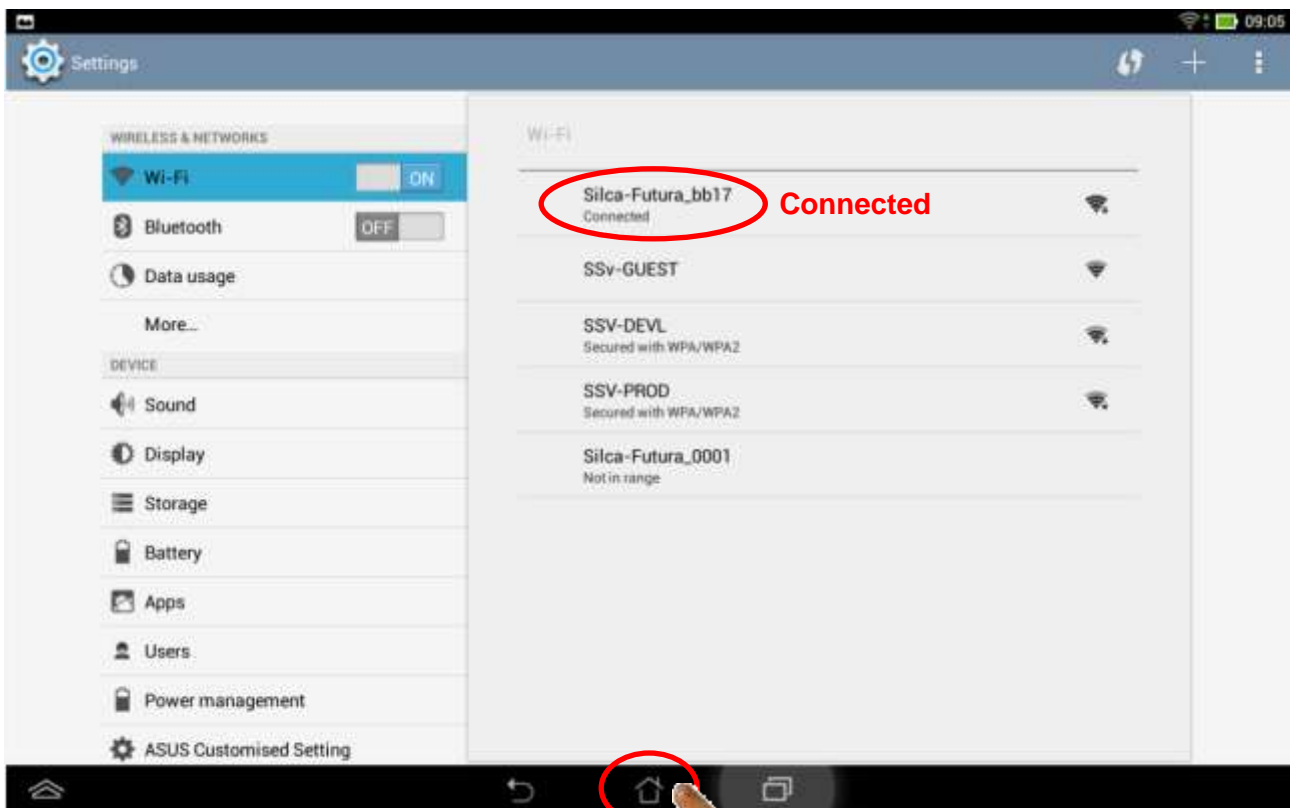
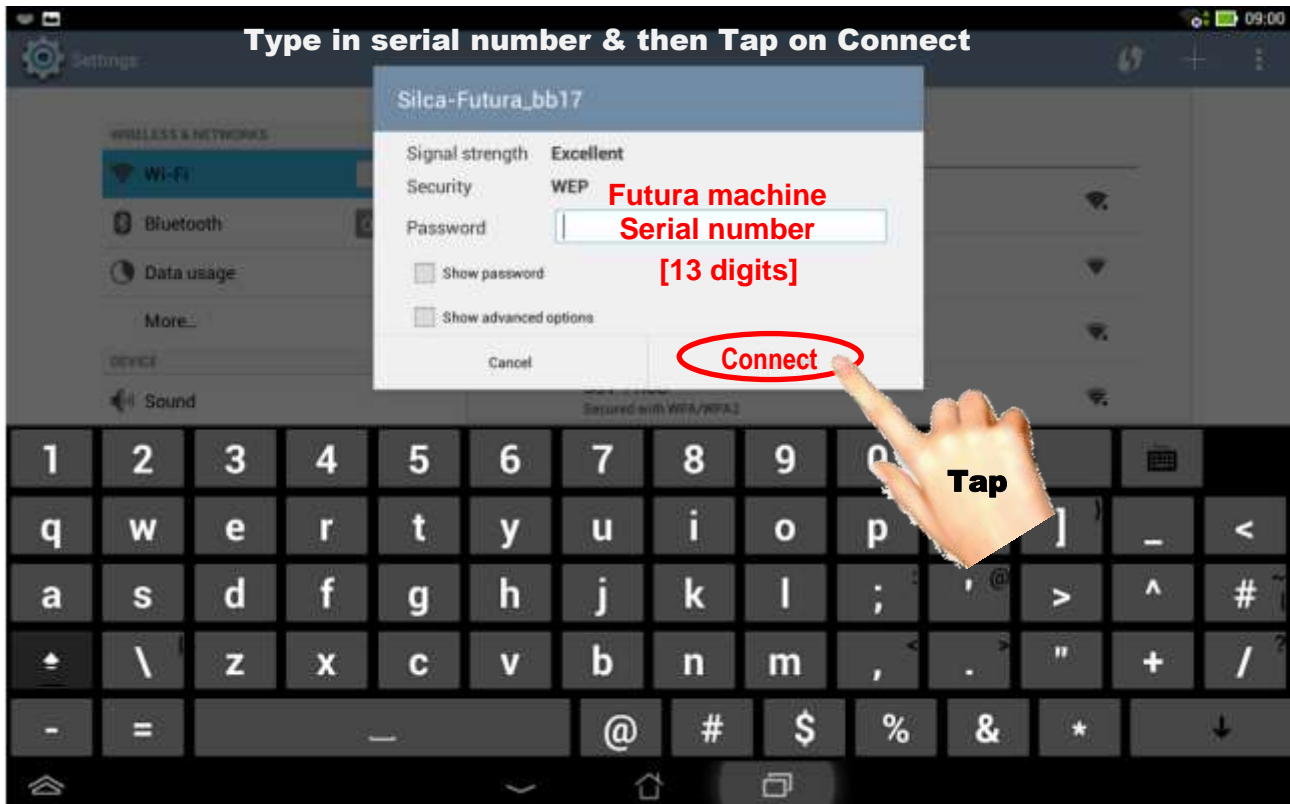

Tap to return to home page

How to correctly quit (exit) the Futura program (application)

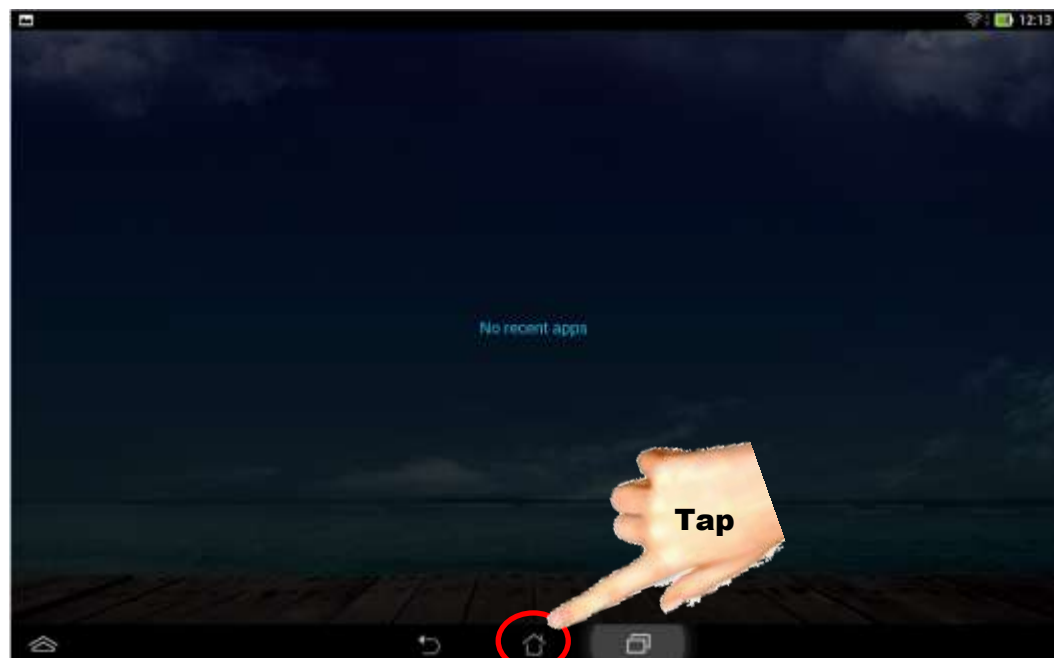
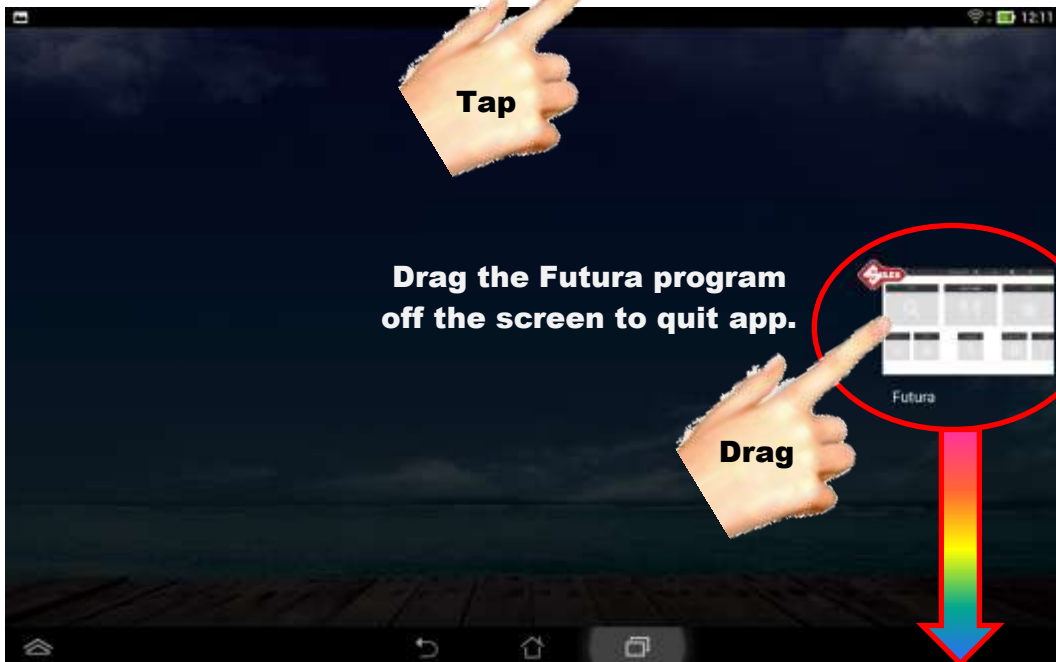
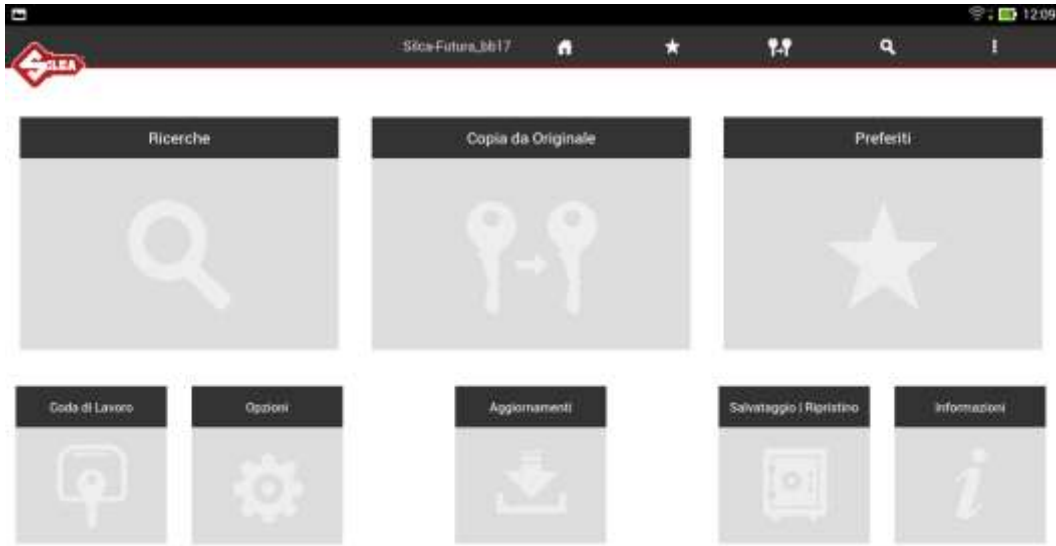

Tap to return to home page

Picking or changing the language in the Futura software (Tablet)

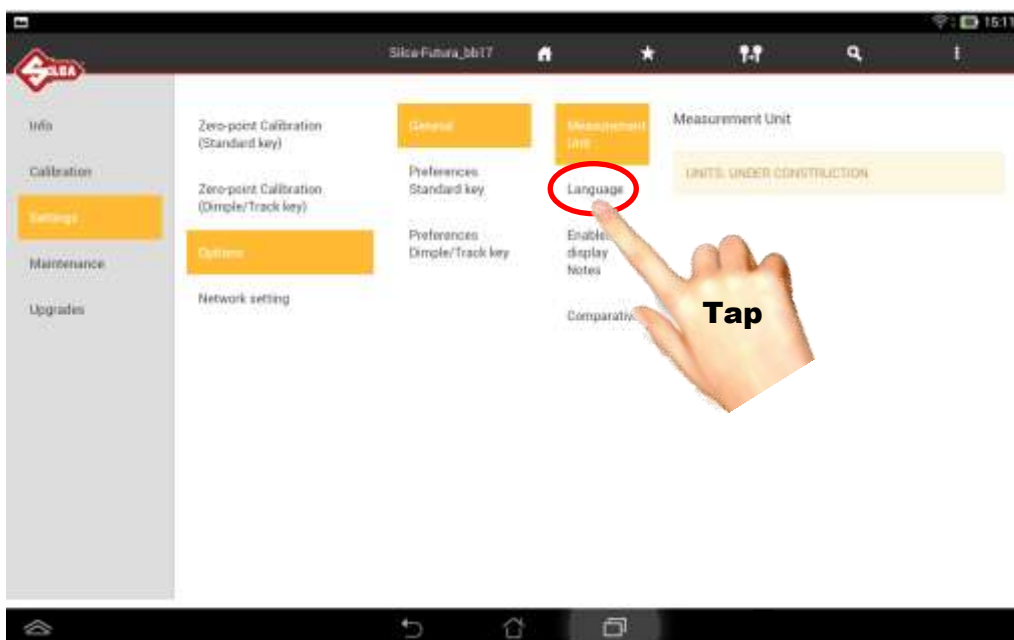

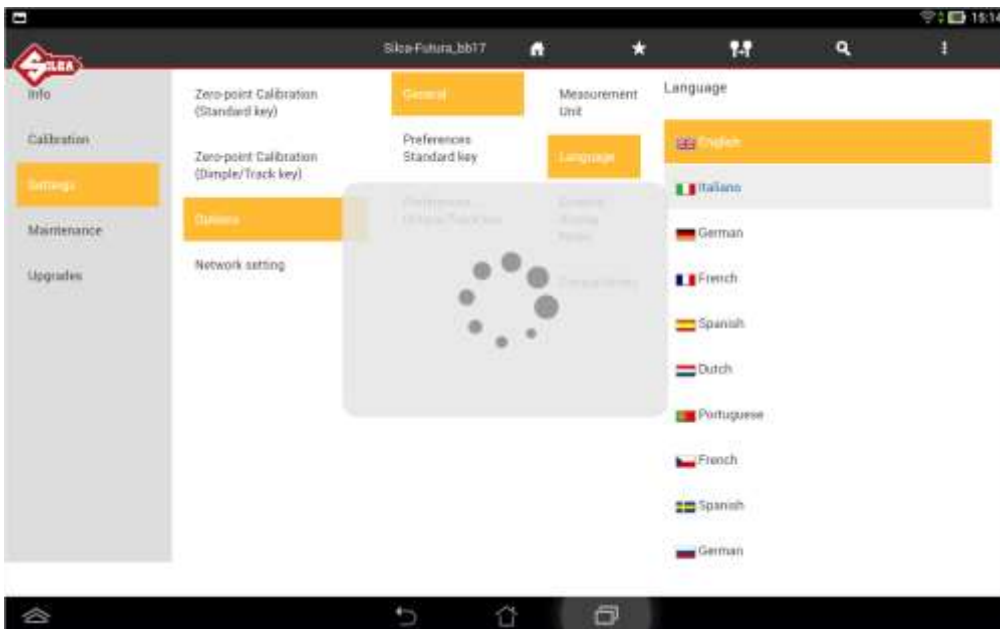
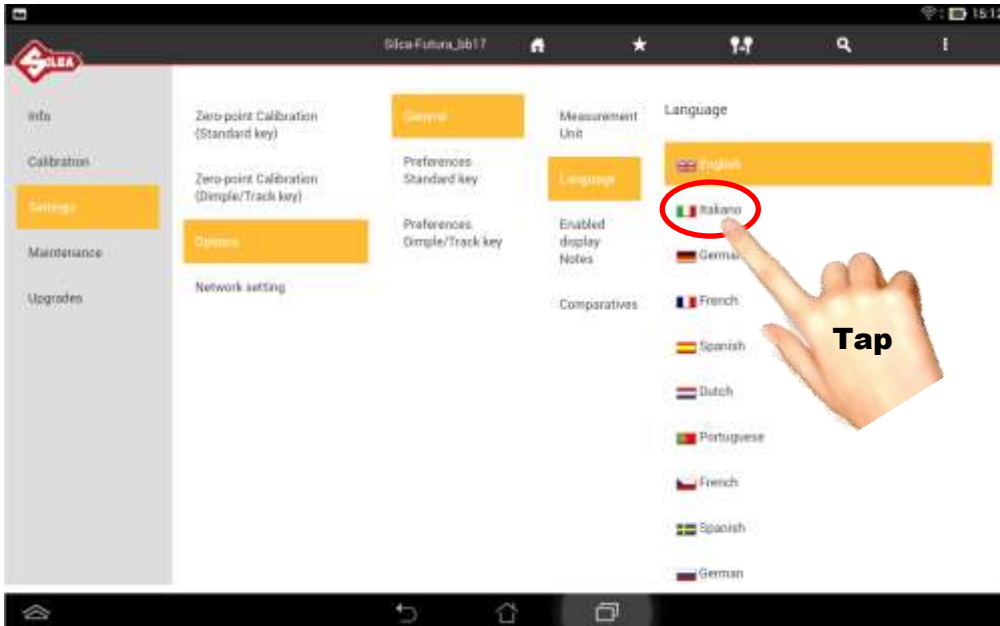

Tap to return to home page

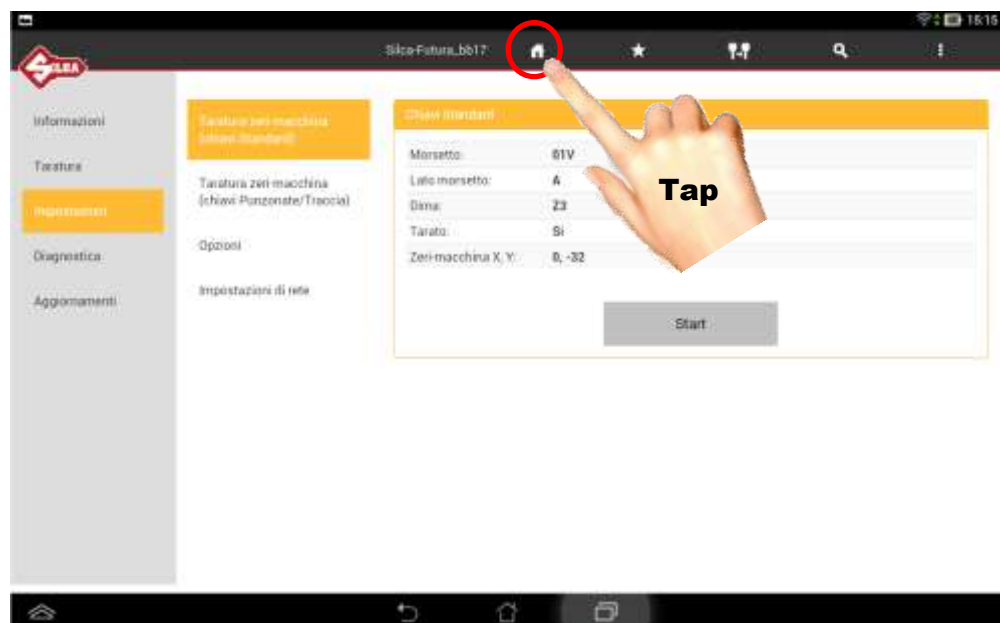

Switching the Tablet on and starting to use the Futura software

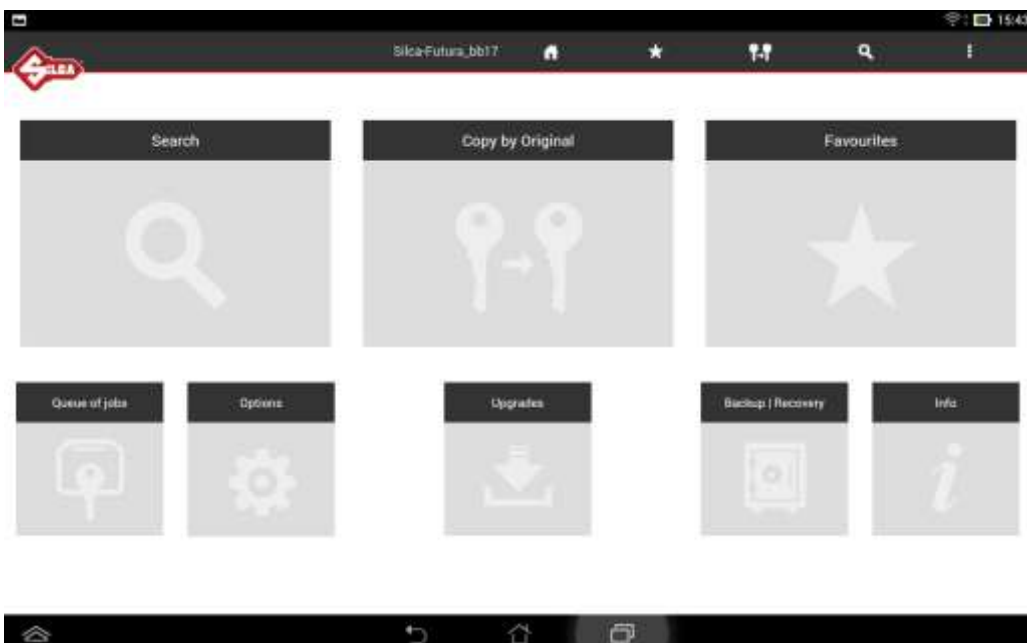
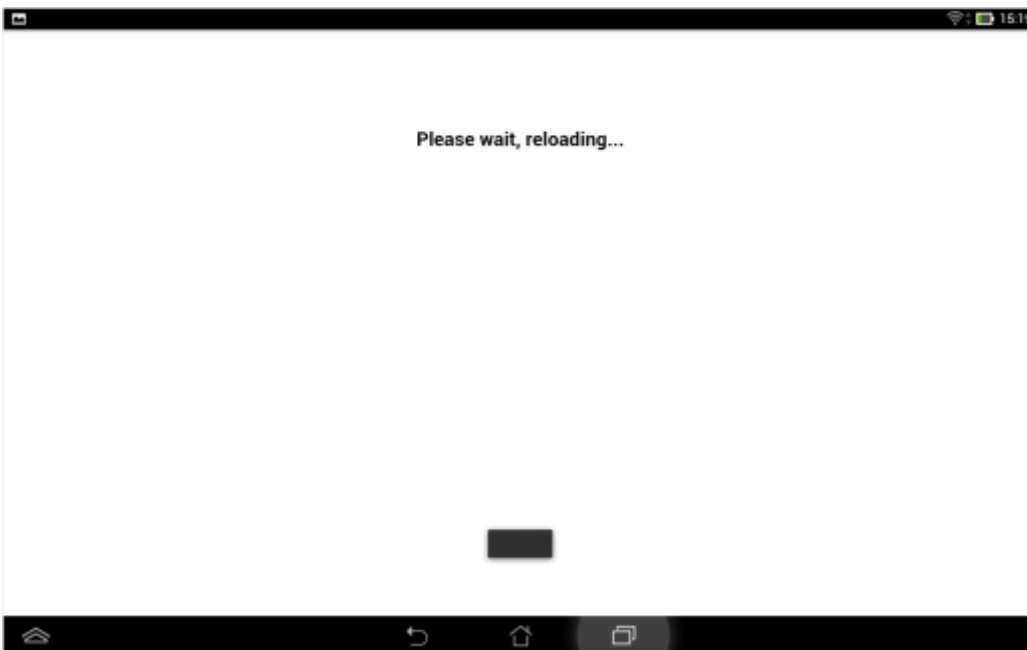

Switching Tablet Wi-Fi Off then On

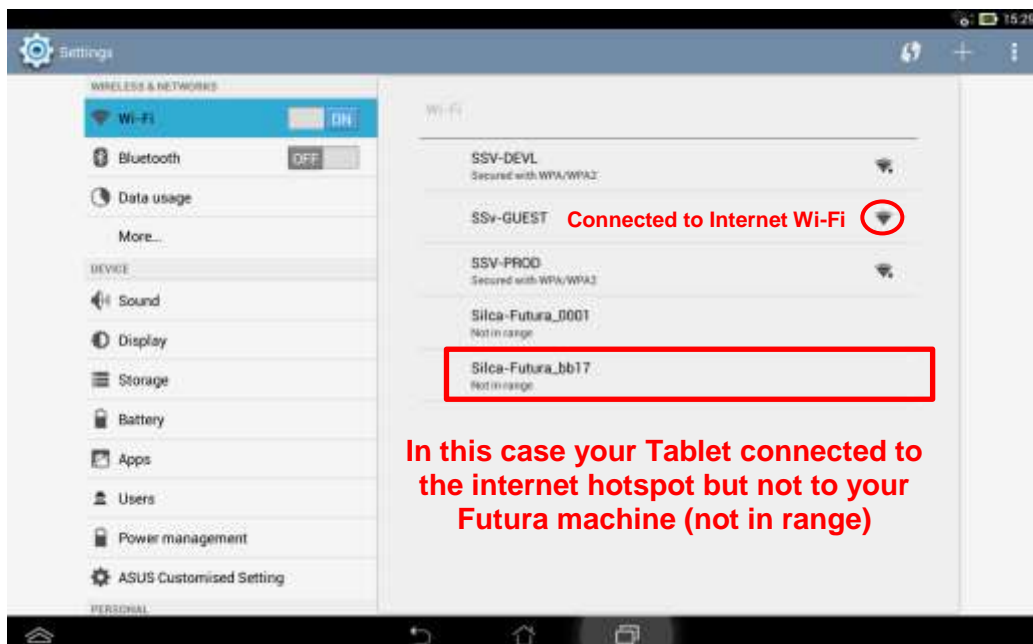
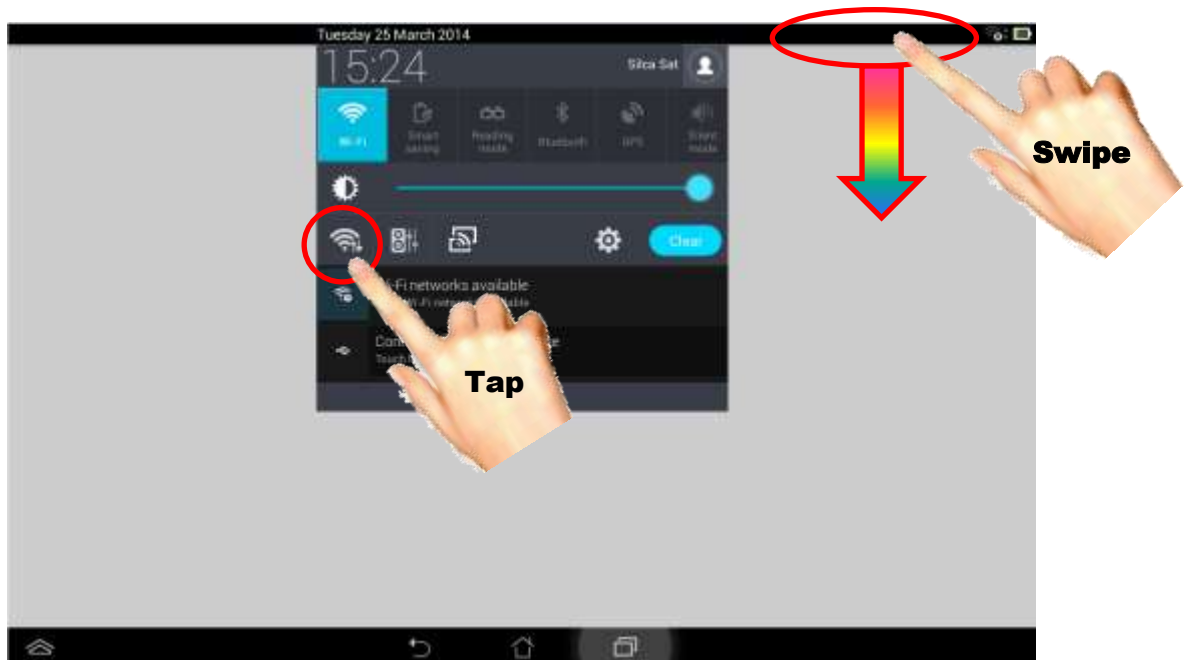
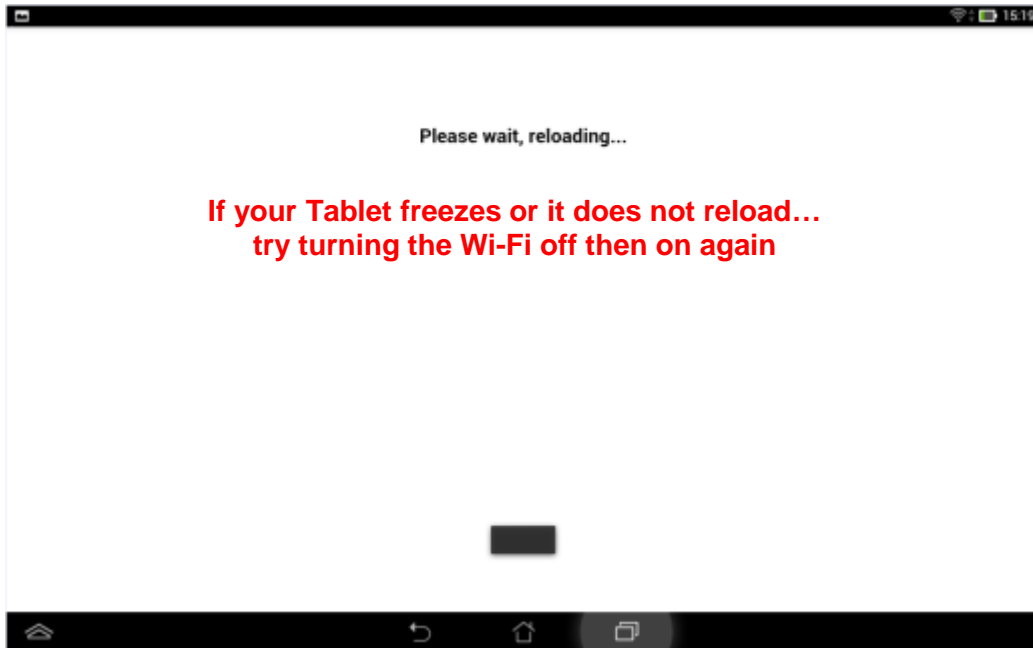

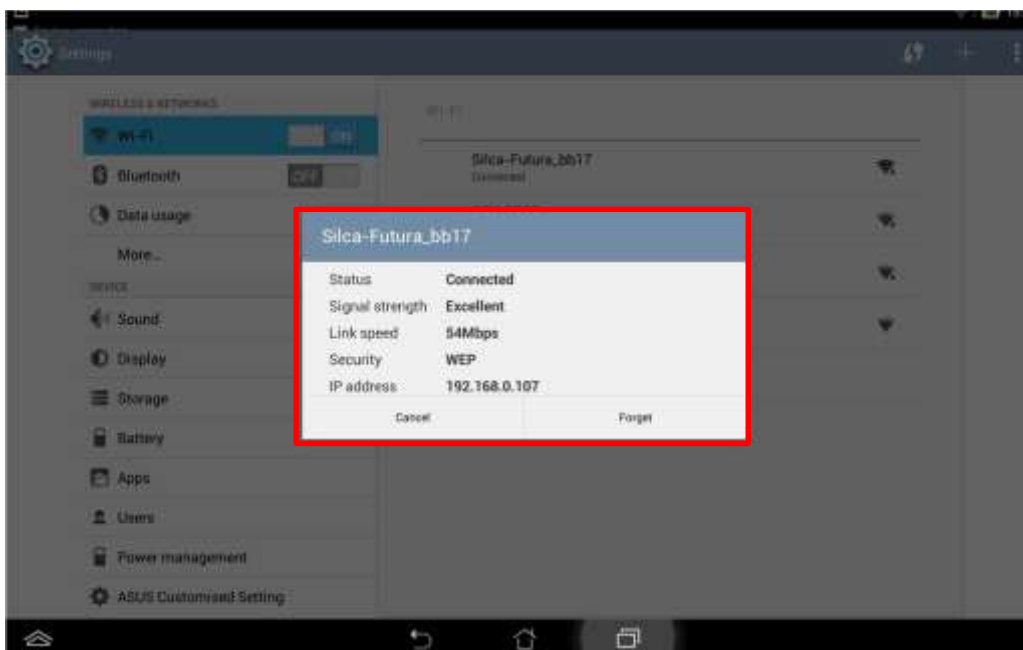
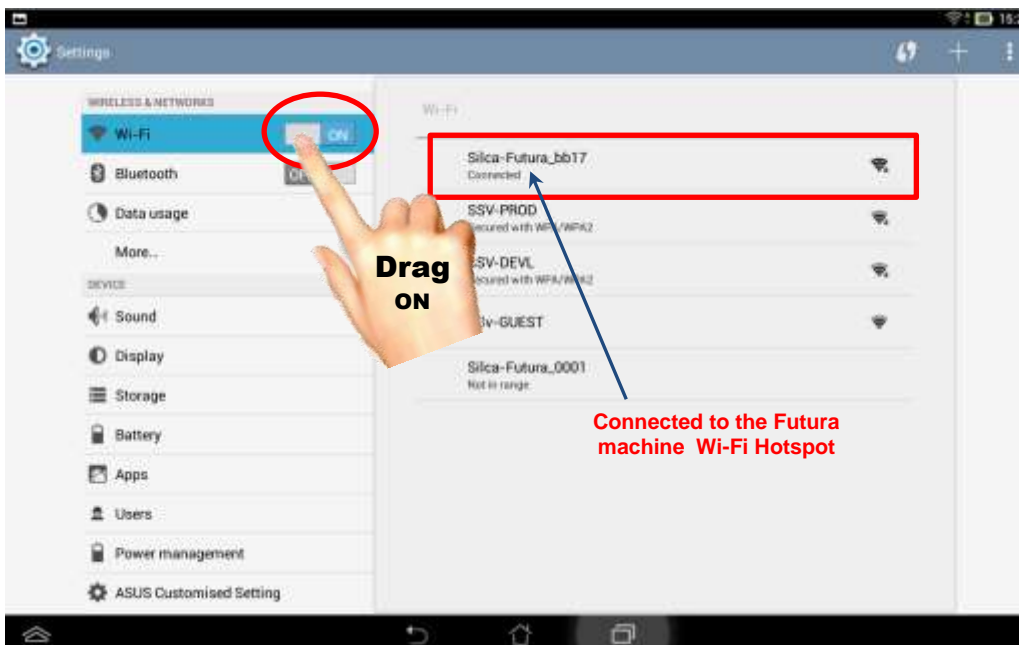
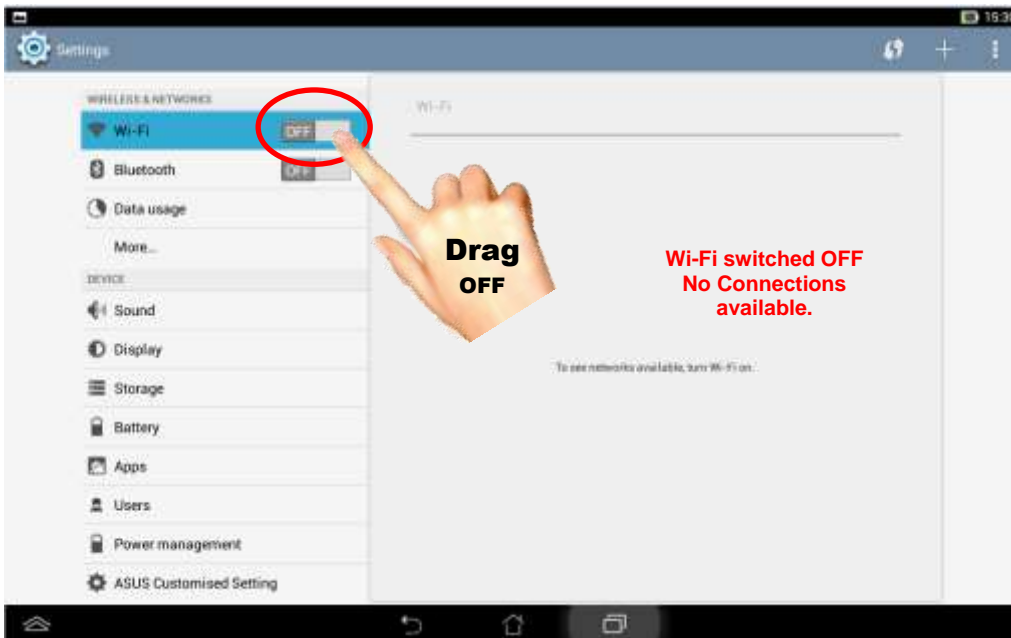

If you get this message just tap on Cancel to keep your Futura machine's Wi-Fi hotspot connection

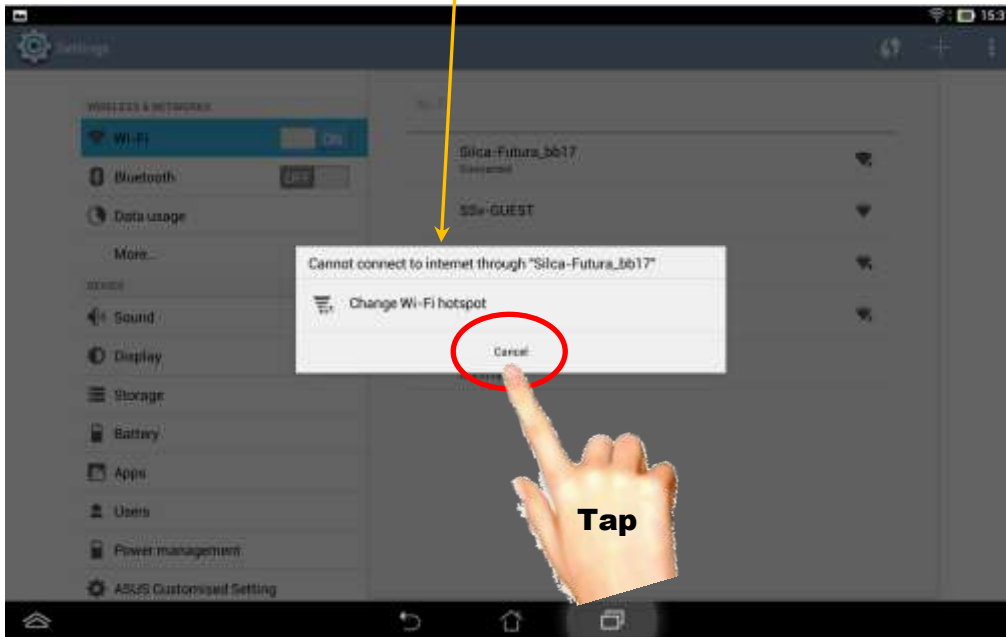

In "Settings" you could also check the Network settings:



Access Point Mode =
Tablet communicates directly to the Futura machine (Wi-Fi hotspot)

Local Network Mode =
Tablet and/or Futura machine communicate through an internet router connection

